

PLAN DE SITUATIE / SITE PLAN
Sc. 1:500

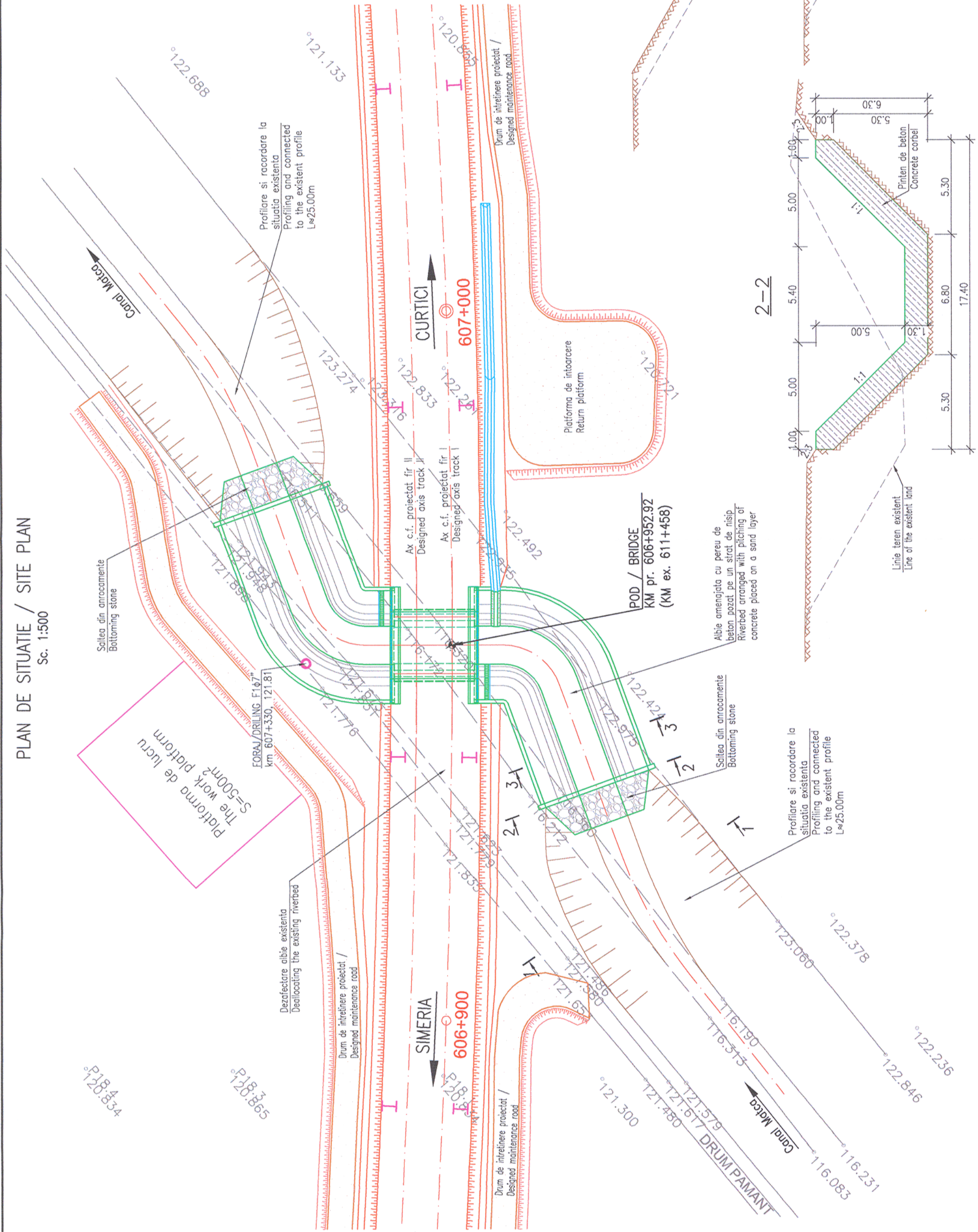

PLAN TRASARE / ALIGNMENT PLAN
Sc. 1:500

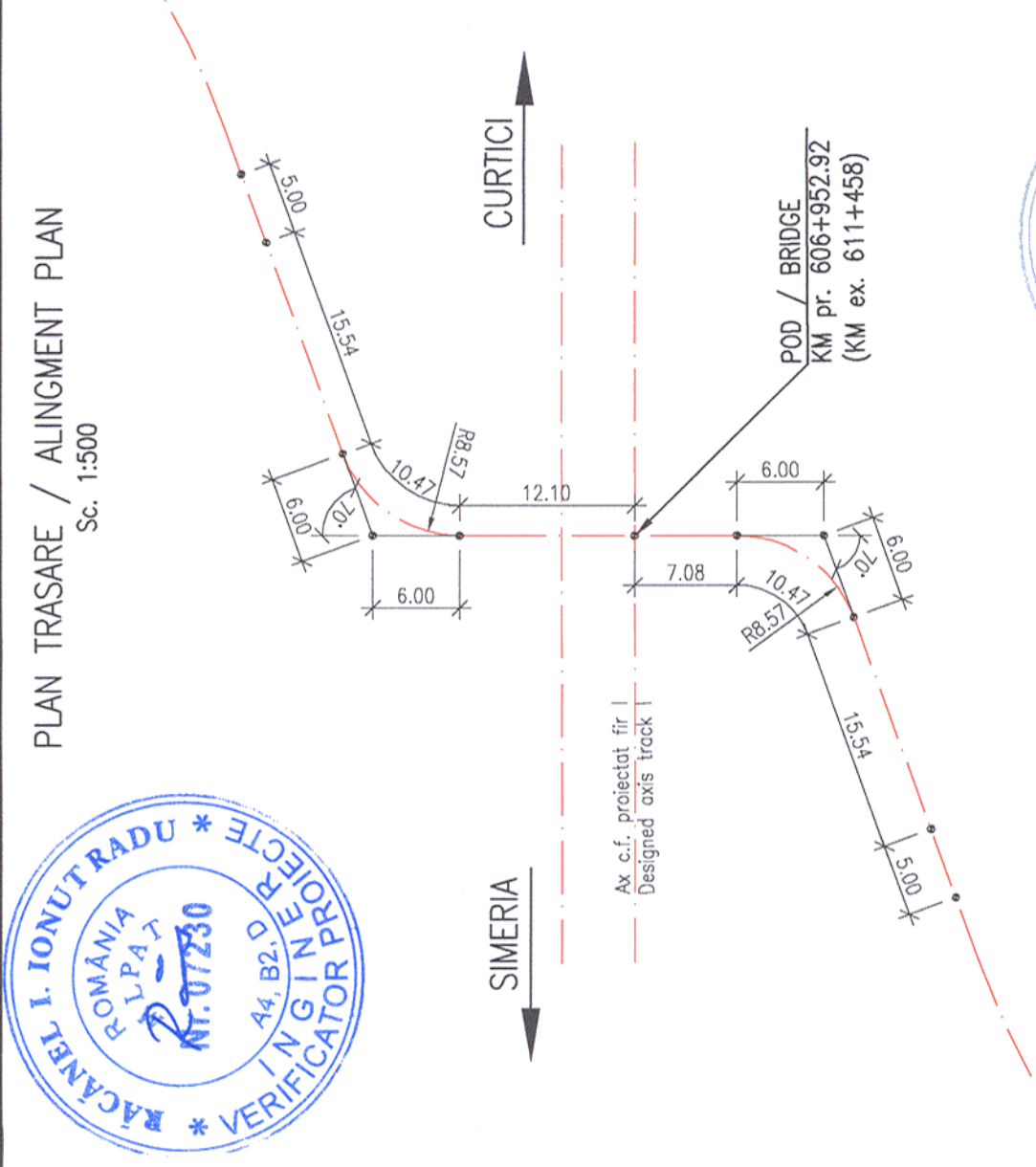

SECTIUNI TRANSVERSALE PRIN ALBIE
CROSS SECTIONS THE RIVERBED
Sc. 1:200

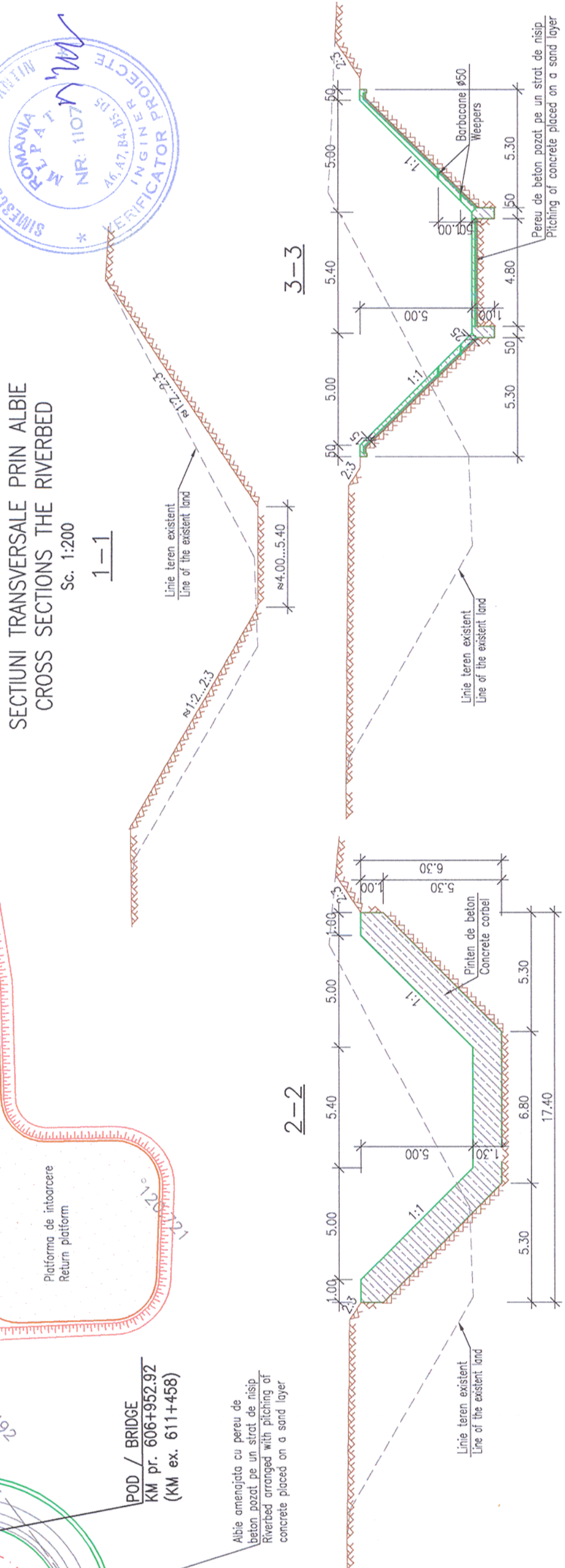

Prezentul plan anuleaza si inlocuieste versiunea anterioara
This plan cancels and replaces previous version

Verificator / Expert Checker / Expert		Semnatura Signature	Referat / Expertiza Report / Expertise
		MINISTERUL TRANSPORTURILOR	
		BENEFICIAR / BENEFICIARY :	
		COMPANIA NATIONALA DE CAI FERATE "CFR" SA	
PROIECTANT / DESIGNER:			
Aprobat Approved	Sef de echipa Team leader	C. Teodorescu	01.2013
Verificat Checked	Expert Cheie Key Expert	R. Tudorascu	01.2013
Subcontractant / Subcontractor			
Aprobat Approved	Adjunct Sef de echipa Deputy Team leader	A.M. Baicu	01.2013
Proiectat Designed	Inginer Engineer	A. Negrei	01.2013
		Project 9i	35311.1
		"Reabilitarea liniei c.f. Frontieră - Curtici - Simeria, parte componentă a coridorului IV Pan - European pentru circulația trenurilor cu viteză maximă de 160 km/h"	
		"Rehabilitation of the Railway Line Border - Curtici - Simeria, component Part of the IV Pan - European Corridor for the Trains Circulation with maximum speed of 160 km/h"	
		Section 2-A : km 614 - end Y Bărzava	
Denumire desen / Drawing name:			
PLAN DE SITUATIE / SITE PLAN			
POD / BRIDGE KM pr. 606+953 (KM ex. 611+458)			
Scara / Scale	1:25000	Revizia / Revision	1 / 04.2013
		Cod desen / Drawing Code	PT.02.02.01.PO.02.02
		Nr / No	02